



1010 FLUSH

The 1010 Flush has no cooling flanges and must be directly mounted on the surface of the vehicle where the metal of the machine is used to create a cooling effect for the light emitting diodes. Thanks to the flush design it is a perfect choice for confined spaces.



TECHNICAL DATA

- Housing Material:** Cast Aluminium
- Mounting Options:** Flush
- Lens Material:** Polycarbonate & Grilamid
- Temperature range:** -
- Connector:** Deutsch (DT04-2P) built in
Mating part: DT06-2S
- Weight:** 413 kg / 0.91 lb
- Light Patterns:** Narrow Symmetric
Medium Symmetric
Wide Symmetric
Medium Asymmetric
Wide Asymmetric
Spot

FEATURES

- Overheating Protection
- Over-voltage Protection
- Polarity Protection
- UL Optional

TEST STANDARDS

- Salt Spray ASTM B117 500 h
- Vibration 5-2000 Hz 3 Axis, 8 Grms
- Shock Tested 50 G 11 ms
- IP69K
- EN55025 / CISPR 25 Class 5
ISO7637-2, ISO16750-2, ISO10605,
ISO11452-2, ISO10452-4, EN61000-4-2, EN61000-4-3
- R10

For further information visit www.tyriLights.com or contact your local sales team.

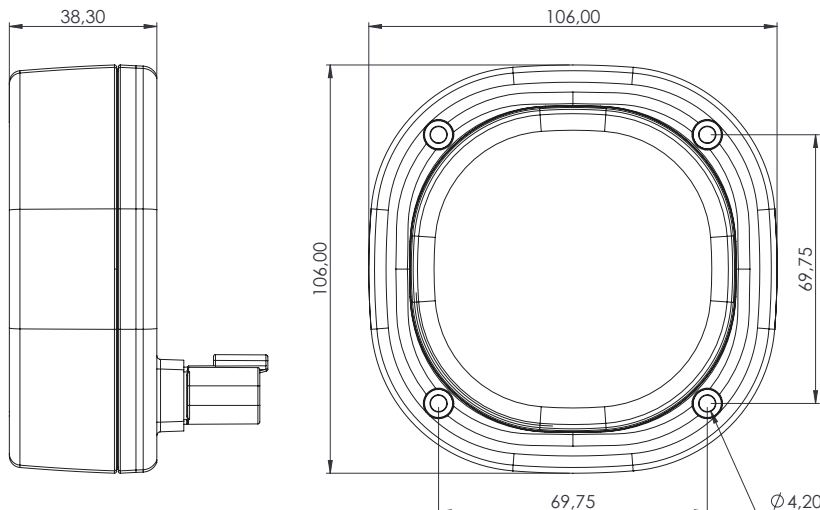



1010 FLUSH

LIGHT OUTPUT	VOLTAGE		AMP DRAW		POWER	COLOR TEMP	LENS PATTERN	PART NO.	EMC	ECE
	Machine	Operating	12 V	24 V	Watts	K			EN55025 / CISPR25	ECE Rating
700 eLm	12-48 V	9-60 V	1.3 A	0.6 A	15 W	5.700 K	Wide Symmetric	CLF-103-1	5	R10
							Wide Asymmetric	CLF-102-1		
1.450 eLm	12-48 V	9-60 V	2.5 A	1.3 A	30 W	5.700 K	Wide Symmetric	CLF-104-1	5	-
1.800 eLm	12-48 V	9-60 V	2.4 A	1.2 A	29 W	5.700 K	-	-	5	R10

LED work lights are exposed to dirt, fertilizers, road salt, acids and more. For best performance and long lifetime, the lens and the cooling fins must be cleaned on a regular basis.